



RKDOORSYSTEMS

Let's make an entrance

Premium door profile

The Premium profile offers an oversized 84mm deep insulated panel construction with overlay panel internally and flush external face with either a flush or classic design frame. This door offers a contemporary door design combined with ultra-high performance and very low U values to allow inclusion in any modern residential or non-fire rated commercial applications.

Performance ratings

- Water tightness: **Class 5A**
- Wind load resistance: **Class C2**
- Air permeability: **Class 4**
- Thermal transmittance: **0.67W/m² K**
- Sound insulation: **44dB**
- Security Certification: **Secure by Design / PAS 24:2022 / RC2 / RC3**

Features & benefits

- ✓ German 75mm deep insulated frame with mechanical & glued corners for high performance construction and life expectancy
- ✓ 94mm laminated quadruple glazing as standard for maximum security
- ✓ Extensive choice of external and internal colours giving maximum design choice
- ✓ Low level threshold as standard for disability access compliance
- ✓ Triple gasket sealing system for high weather performance
- ✓ Hidden fixing system with cover trims to frame & door sash for minimal maintenance and clean look appearance
- ✓ Available with 180 deg concealed hinges for minimal flush look internally and maximum opening
- ✓ 316 Grade Stainless steel handles & fittings suitable for all locations
- ✓ Sidelights and fanlights in single frame construction offering minimal frame design
- ✓ Optional custom design or glass etching for individual design
- ✓ Available with motorised locking for use with finger scan locking systems and home smart properties
- ✓ Secure By Design and PAS 24 Certified for full new build compliance
- ✓ Optional 25mm high projecting cills for ease of installation



Official Police Security Initiative



Call **01872 222300**

Email **info@rkdoorsystems.co.uk**

Design your door at **www.rkdoorsystems.co.uk**

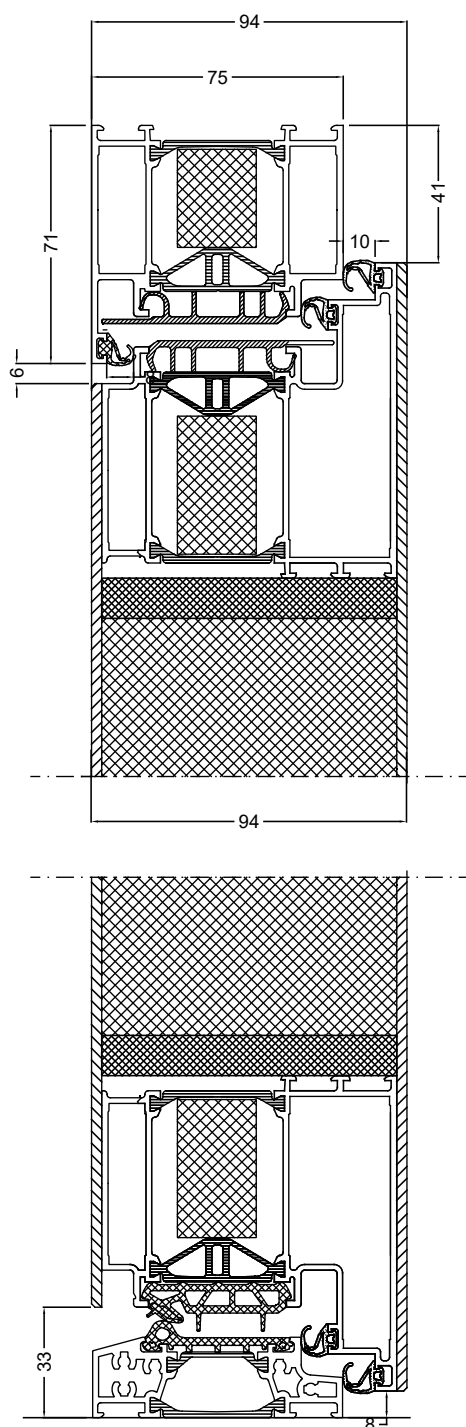

Specification

| | | |
|------------------------------------|--|----------------------------|
| Dimensions | Frame depth | 75mm |
| | Door sash depth | 94mm fully insulated |
| | Visible frame (single door) | 71mm |
| | Visible frame (with sidelight or fanlight) | 65mm |
| | Glass thickness | 94mm triple security glass |
| | Max single opening door width | 1300mm (incl frame) |
| | Max single opening door height | 3000mm (incl frame) |
| | Max sidelight width | 2000mm |
| | Max fanlight height | 2500mm |
| Frame & Design Options | Flush square | ✓ |
| | 85/95mm Classic frame | ✓ |
| | Glass Sidelights | ✓ |
| | Glass Fanlights | ✓ |
| | Opening Sidelights | ✓ |
| | Pair of doors | ✓ |
| | Outward opening | ✓ |
| | Custom Designs | ✓ |
| | Pivot opening | ✓ |
| | Frame extensions | ✓ |
| Colour & Finish Options | 16 Standard RAL colours | ✓ |
| | Non standard RAL colour | ✓ |
| | Timber finishes | ✓ |
| | Metallic Colours | ✓ |
| | Dual finish | ✓ |
| | Matt or Finestructure finish | ✓ |
| | Elite special ceramic finishes | ✓ |
| | Elite special metal finishes | ✓ |

